



# Robin Hood Line



## Community Rail Partnership

## Annual Report 2022





## Foreword



As the lead officer for the newly formed Robin Hood Line Community Rail Partnership (CRP), it's been a very busy but successful 12-months. The success of the last 12-months wouldn't have been possible without the support of both Kaye Robinson and Donna Adams from East Midlands Railway (EMR).

I am pleased to share with you the first annual report for 2022/2023, the milestones that have been achieved along with successful projects that have been delivered and the aspirations for the coming year.

*Arron Johnson, Partnership Policy and Community Rail Officer*



I am pleased to welcome you to our first annual report and hope you will join me celebrating a successful year for the Partnership. As you will read in this report much has been achieved over the year and it is brilliant to see so much enthusiasm along the Robin Hood Line from all involved – partners, volunteers, stakeholders, rail industry, funders and our own officers. It has been a great example of partnership working with so much achieved over the year, and so much planned for the coming months. I am looking forward to the coming year, seeing existing projects flourish and new projects start to take off, I hope you are too and finally, thank you for your continuing support.

*Chris Fridlington, Chair of the RHL CRP*







## Robin Hood Line

The Robin Hood Line is a CRP which runs from Worksop to Nottingham with 13 stations in total cutting through various Parish, District, County and City wards.

The line is rich in heritage with an abundance of nature, historical and leisure attractions within easy reach of the 13 stations.

The CRP is working towards becoming an accredited line supported by the Department for Transport (DfT) working with EMR as the main train operating company and other partners. The CRP follows the Community Rail Development Strategy working on the four pillars as follows:

1. Provide a voice for the community
2. Promote sustainable, healthy and accessible travel
3. Bring communities together to support diversity and inclusion
4. Promote social and economic development

The CRP is supported by:

- Ashfield District Council • Bolsover District Council • Community Rail Network
- Community Safety Partnership • CrossCountry Trains • Department for Transport
- Derbyshire County Council • East Midlands Railway • Elmton-with-Creswell Parish Council
- Langwith Parish Council • Mansfield District Council • Nottingham County Council
- Shirebrook Town Council • Whitwell Parish Council





# East Midlands Railway

EMR, owned by Abellio, is the main train operating company in our region. EMR is committed to working closely with Community Rail lines across their network. The Robin Hood Line is the tenth and newest CRP. As part of their commitment obligation to the Department for Transport there are several funding options for CRP's and station adoption groups to bid in to, to support projects along their lines.

[eastmidlandsrailway.co.uk](http://eastmidlandsrailway.co.uk)



## Financial Statement/Profile

A total of **£152,540.55** has been secured in funding from the following partners into the CRP since the inception in September 2021.

The total spend so far has been **£73,532.45**

The expenditure has included the following projects:

- Creswell Rail Discovery Trail
- Distraction Project/You vs Train Initiative three-month Pilot
- Distraction project/You vs Train 48-week Programme
- Website and rebranding
- Whitwell Station Land Development 1st phase
- Heritage Interpretation Project

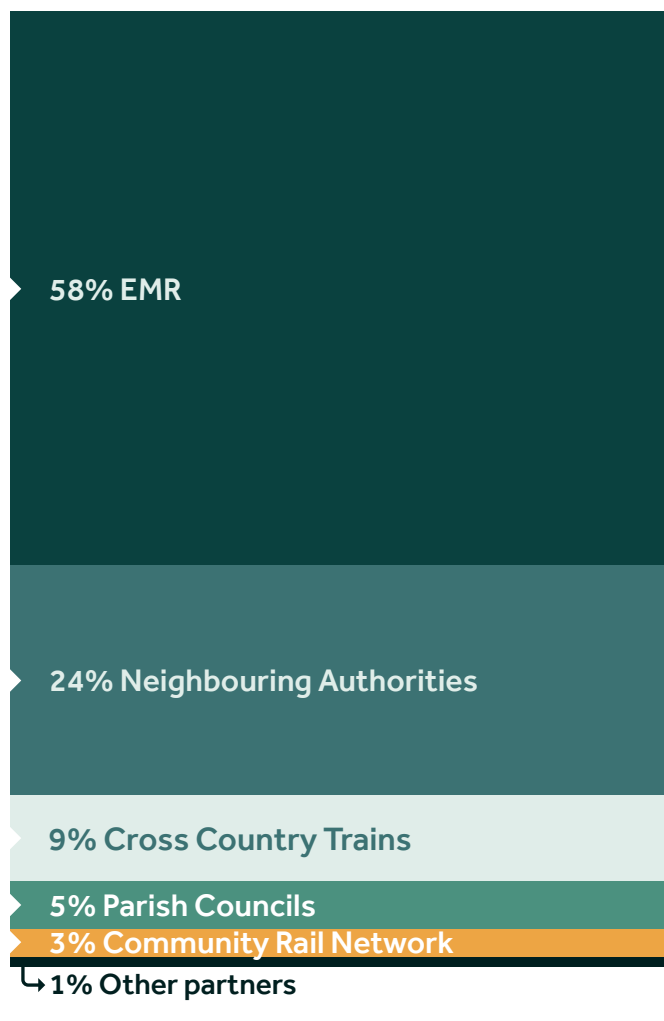



# Milestones and Achievements

1. September 2021- Officer employed and hosted by Bolsover District Council.
2. September 2021 to April 2021-Partner Engagement, Chair and Vice chair appointed to the Community Rail Partnership.
3. October 2021- Station Adopters secured for Whitwell, Langwith and Creswell Train Stations.
4. January 2022- Inaugural Community Rail Partnership meeting held with multiple partners. Live Activity Plan presented and agreed by all partners.
5. February 2022- Launch of distraction project utilising the You vs Train Initiative.
6. March 2022- Bolsover District Council show their commitment to the rail partnership and employ a second officer in an operational capacity, giving FTE with the lead officer becoming the strategic lead.
7. April 2022- Second Community Rail Partnership meeting held, signing of the Terms Of reference by all partners contributing financially. Launch of the Creswell Rail Discovery Trail.
8. May 2022- Due to the success of the distraction project, this has now become a sustainable project running for 48-weeks of the year financially backed by Bolsover district Council, EMR and the Community Safety Partnership.
9. June 2022- First school trip with Flying High Academy from Mansfield utilising the train and visiting Creswell Crags through the Rail Discovery Trail (*see page 9 for more details*). Both the Creswell Discovery Trail and the distraction project have been submitted for awards to Community Rail Network.
10. July 2022 - Land at Whitwell station signed over to station adopter group Just Good Friends on a peppercorn lease. The land development will be the flagship project for this year from local building company the Chapman Brothers.
11. Funding secured through EMR, Cross Country Trains and Community Rail network for the Heritage Interpretation project that consists of:
  - Interpretation boards for each railway station
  - Booklet on the history of the line
  - Travelling exhibition
  - Talks (one in each location)
12. August 2022 - More trips on the train for a local church group and Rhubarb Farm to visit the Creswell Discovery Trail.
13. September 2022 - Launch of the brand new website and rebranding for the Robin Hood Line after securing funding from EMR, Cross Country Trains and Community Rail Network.
14. September 2022 - Land clearance commences on the Whitwell station project.
15. September 2022 - Research begins for the Heritage Interpretation Project.





# Engaging with young people

The Robin Hood Line Community Rail partnership was established in September 2021 during the Covid-19 pandemic. This meant that initial engagement with schools and community groups was very limited.

This was a perfect opportunity to highlight projects for the stations and include local historic attractions that would be utilised to engage the young people within easy reach of the stations and visitors alike. What a success it has been in such a short space of time.



## Events

- A social action day has taken place at Sutton Parkway Station involving the station adopters and local volunteers to clean up the station platforms and the car park that is situated at the train station. This included litter picking and weeding of the areas.
- Rhubarb Farm and Building Lives Around Shirebrook Town (BLAST) Craft Club have designed some art work and poppy displays for the train stations at Langwith and Shirebrook as part of the routes to remembrance.



# Robin Hood Line in numbers:

Funding secured: **£152,540.55**

Number of stations adopted: **11**

Number of station adopters: **29**



## Mansfield Football Club in the Community

A partnership has been established with Mansfield Town Football Club in the community and First Art to develop a project proposal to work with local schools in Mansfield to design artwork for the station and



complete other activities such as litter picking and general tidying up of the area. This will also involve three-days at the football club where activities will take place around rail safety, healthy eating, stadium tour and physical activity sessions along with a trip on the train to visit Creswell Crags. This project will be run as a pilot and if successful, which I'm sure it will, will be replicated in other areas and the schools in the catchment area.

## Website and Rebranding

The website is due to go live in October after securing funding for the rebranding and logo development to be used on social media platforms and any publications, alongside the development of the website from East Midlands Rail, Cross Country Trains and Community Rail Network.

This has involved a lot of research and working with partners of the CRP to build the content of the website. We are very pleased with the result and can't wait to share the platform to showcase the CRP and the opportunities along the line including:

- Leisure and Tourism
- Family Days and Events
- Walking and Cycling
- Skills and Employment

Take a look at the website on [robinhoodline.com](http://robinhoodline.com)

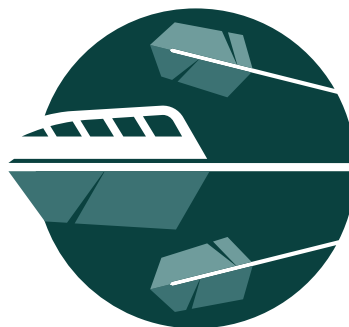

## Robin Hood Line







## Distraction Project

A project to help tackle nuisance behaviour at train stations in Bolsover District has been hailed as a success. The You Vs Train initiative targeted the station areas of Whitwell, Creswell, Langwith/Whaley Thorns and Shirebrook and aimed to reduce instances of anti-social behaviour and help local residents feel safer. Multi-sports sessions were held alongside important rail safety talks to not only engage with young people but to help keep them safe as well.

The sessions were a huge success with almost 100 people actively engaged and almost 500 attendees over the project lifespan. Following the project there was a noticeable downturn in the number of young people hanging around the station areas, a reduction in anti-social behaviour and a greater feeling of safety within the community.

Due to the success of this pilot, project funding was secured to deliver the project for 48-weeks of the year. This has allowed us to start to engage other services with the young people, including community safety, skills and employment.

Bolsover District Council's Cabinet Member for Enforcement, Councillor Mary Dooley said: "We have a responsibility to all our residents, including young people. We didn't want to create a barrier between us and them so decided to engage with them. This worked wonderfully and you can see the difference it's made with less anti-social behaviour and residents feeling safer."

The project was a joint effort between Bolsover District Council, EMR, Whitwell Parish Council, Elmton-with-Creswell Parish Council, Langwith Parish Council, Shirebrook Town Council and the CRP.

EMR came out to film the session and interview the sports development team.

Here are some testimonies from some of the participants:

"The sessions are really enjoyable, I've managed to make lots of new friends and learn new skills" - Max Parker

"I've gained knowledge about the dangers of stepping onto the tracks and the consequences of it. I really enjoy the sessions the games are different every week and I like how the coaches deliver the sessions" - Kian Martin

"The coaches are amazing and always make the sessions fun and enjoyable. I've also learnt lots about the dangers of the railways and how to behave around the tracks" - Kobe Edwards

"I was worried about the football sessions at first as I'd not played much football before but now I've gained more confidence from playing and now really enjoy coming to the session very week to bet better!" - Alisha island

"I never knew that you could get fined a £1000 for walking on the tracks and that it's illegal to do so as well. I also enjoy the sessions and how the coaches play music to add more atmosphere to the sessions" - Charlie Harrison

"The sessions are really fun and I enjoy playing different sports every week. I've managed to make new friends and learn about the railways as well" - Angel Kent





# Creswell Crags Rail Discovery Trail

One of the first things that Community Rail Officer (CRO) noticed when they came in to post was that there is nothing along the Robin Hood Line to promote Creswell Crags exists or is accessible from the train station.

Creswell Crags is a journey through time to the ice age. A story of resilience, adaptation, creativity and a unique tourist attraction situated on the border of Derbyshire and Nottinghamshire.

The CRO soon set about developing a project proposal for the Rail Discovery Trail. What a success it's been!

Four trips have now taken place accessing the Creswell Rail Discovery Trail via the train. These have included two classes of 30 children from the Flying High Academy at Mansfield, a local BAME church group and Rhubarb Farm our station adoption group for Langwith who provide an excellent service to the local communities, with more schools and community groups currently being engaged through rail safety talks and the opportunity to visit the trail via the train.

The collector's booklets can be found in multiple places, collected from a local convenience store or downloaded via the QR code:

The trail has seen a spike in visitors using the trail totalling 123 from several different postcode areas.

A video promotion from a recent school visit can be found here:

<https://vimeo.com/720599199/d45e932ec9>



# Flagship Project

A strip of land has been secured at Whitwell station and signed over to Just Good Friends the station adopter group on a peppercorn lease.

The land will be developed into a community space with a sensory garden and disabled access. There will be space for school children to develop and aid with educational needs. This will allow schools that have access to the Robin Hood Line to visit the community garden and the have opportunity to learn about horticulture and experience using the train.

The first phase of the project is now complete with the land clearance.

Plans have now gone out to tender for the development of the land.

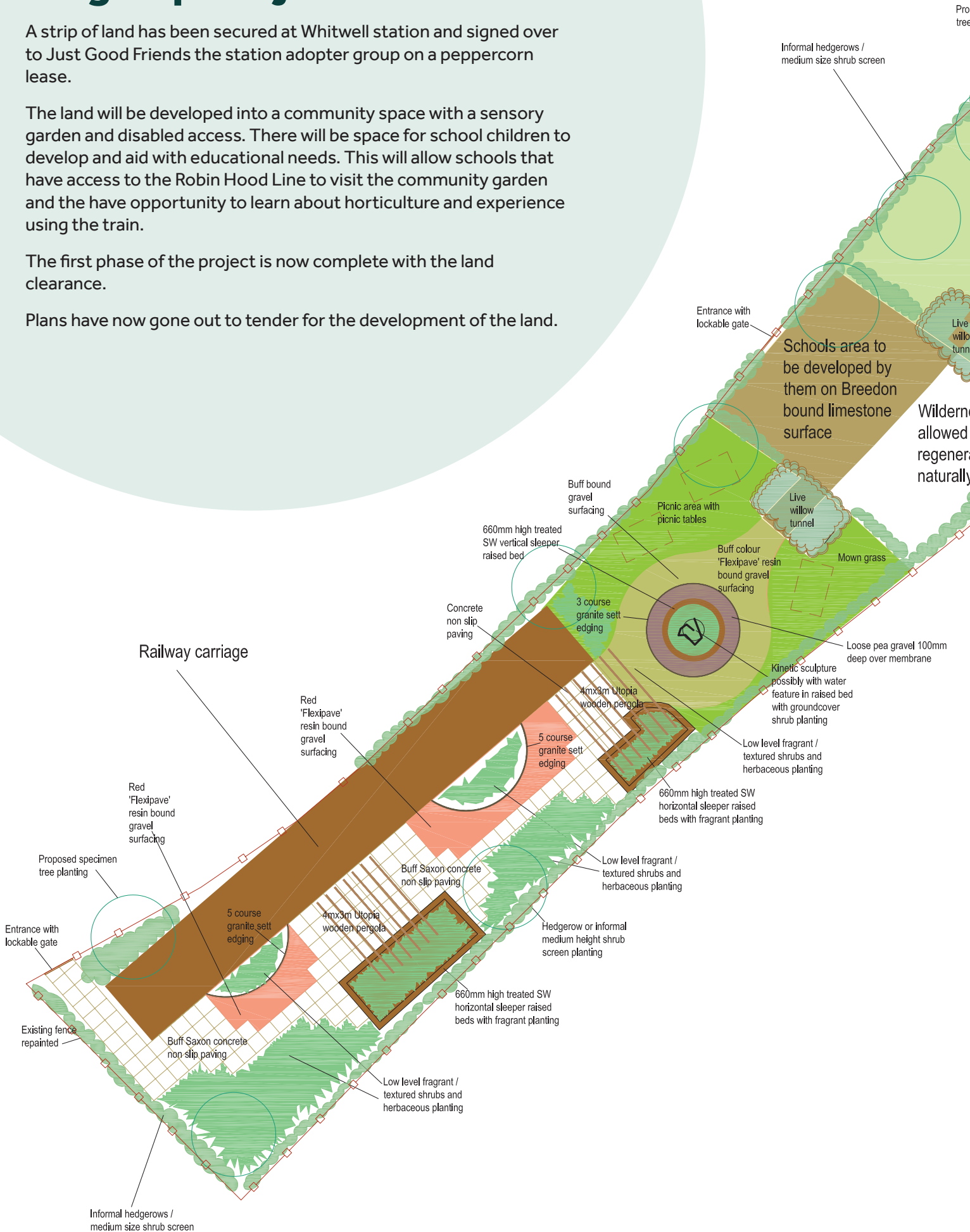





---

## The Community Rail Partnership is supported by:

- Ashfield District Council • Bolsover District Council • Community Rail Network • Community Safety Partnership • CrossCountry Trains
  - Department for Transport • Derbyshire County Council
- East Midlands Railway • Elmtun-with-Creswell Parish Council
  - Langwith Parish Council • Mansfield District Council
- Nottingham County Council • Shirebrook Town Council
  - Whitwell Parish Council

